

NO DIMENSIONS TO BE SCALED FROM THIS DRAWING

This drawing is issued for the sole and exclusive use of the named recipient. Distribution to any third party is on the strict understanding that no liability is accepted by Pick Everard for any discrepancies, errors or omissions that may be present, and no guarantee is offered as to the accuracy of information shown

CDM - RESIDUAL RISKS

The following are considered to be significant risks relevant to this drawing, which could not be fully mitigated or removed through design. Further possible control measures have been identified within the Design Risk Assessments which may help to mitigate these and other identified risks further during the construction / maintenance process;

Notes

1. This drawing shall be read in conjunction with the specification and all other relevant drawings and documentation.
2. Positions of equipment are indicative only. Exact position shall be determined on site by the Contractor.
3. Ensure electrical services are fully co-ordinated with the mechanical services installation.
4. Refer to E0800 for schedules and legends.

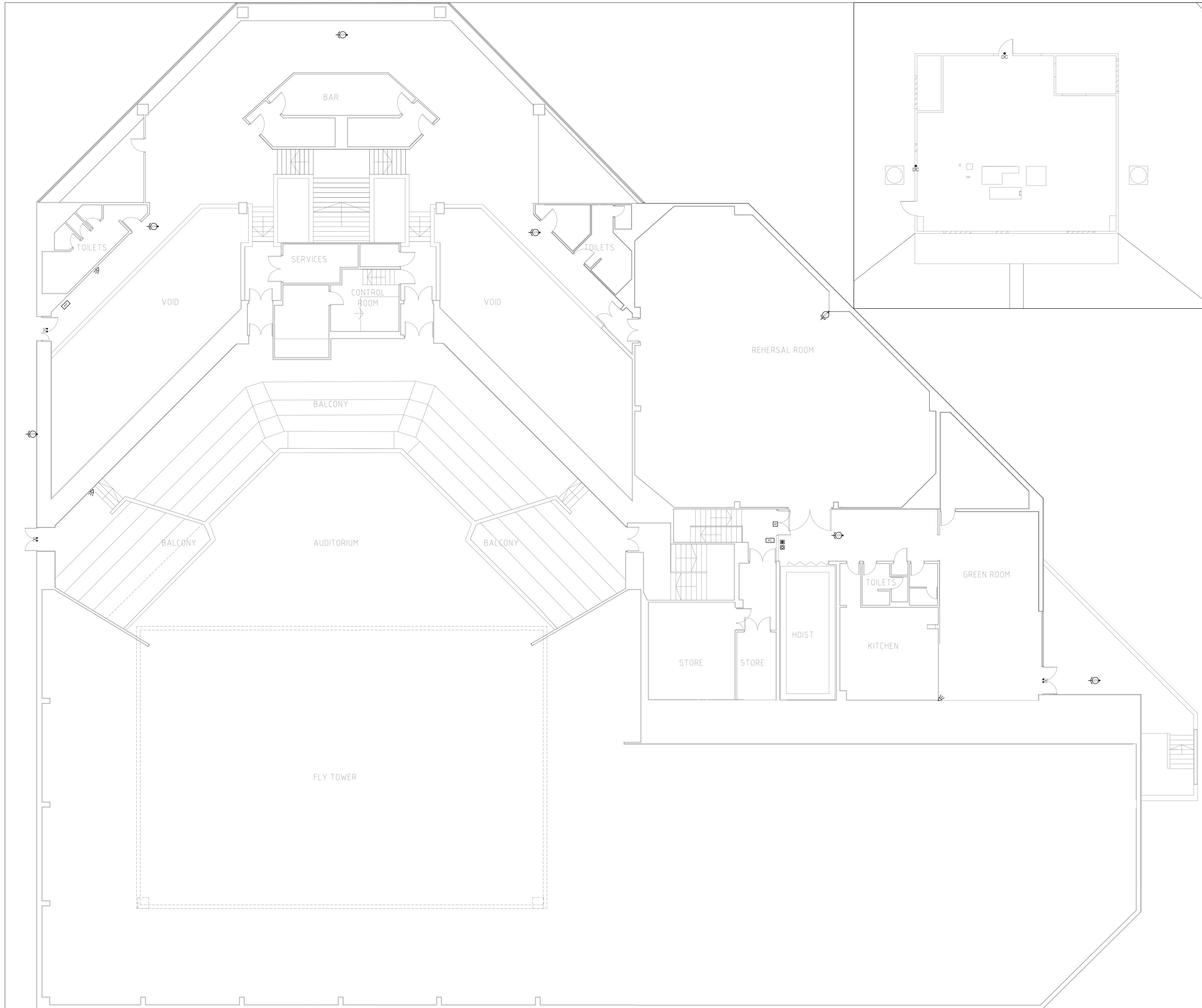

P01	Tender issue	11.12.15	ECN	LDB
Revisions		Date	Drawn	Chk'd

CLIENT
Leicester City Council

Architects
 Consulting Engineers
 Project Managers
 Surveyors

PICK EVERARD
 Halford House
 Charles Street
 Leicester
 LE1 1HA
 Phone 0116 223 4400
 Fax 0116 223 4411/22/33
 consultants@pickeverard.co.uk
 www.pickeverard.co.uk

PROJECT
Haymarket Theatre

DRAWING TITLE Proposed Security Layout Level 05	PICK EVERARD PROJECT No. 140958 SCALE - unless otherwise stated 1:100 at A1 STATUS PURPOSE OF ISSUE D2 TENDER
DRAWING NUMBER LEI001-PE-XX-05-DR-E-0403	REV P01